

1000 TOWBIN AVENUE @ CORPORATE PARK

Lakewood

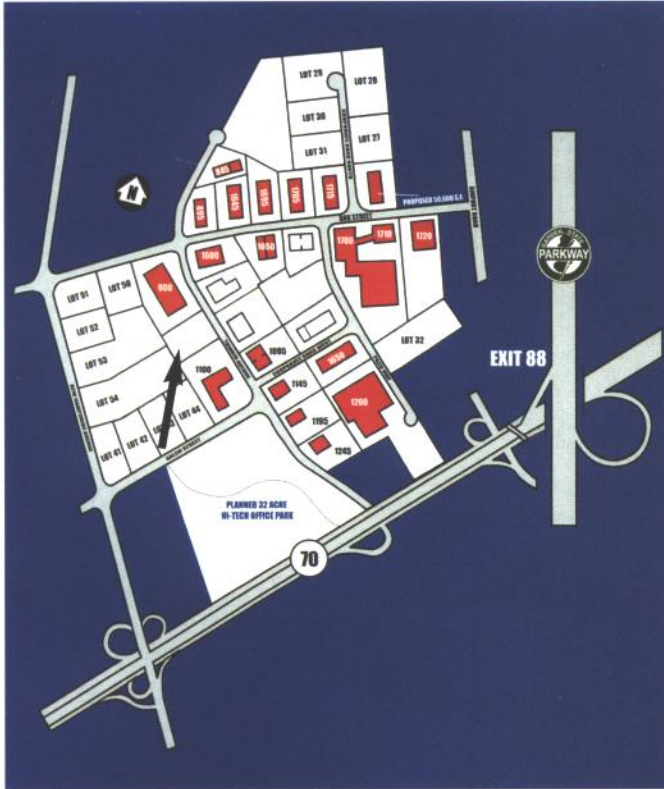

Features/Specifications

- Total Building Size: 50,000 Square Feet - Divisible
- Bay Size: 40' X 40'
- Dock-High Doors: 11
- Drive-In Doors: 1
- Fully Sprinklered ESRF System
- Clear Height Under Steel: 29 Feet At Low Point
- Electric: 400 amp, 277/480 Volt, 3-Phase, Divisible
- 5" Reinforced Concrete Slab on Grade
- Pre-cast Panel
- Urban Enterprise Zone/Foreign Trade Zone
- Air Conditioned Office Area
- Gas Heat
- Public Water and Sewer

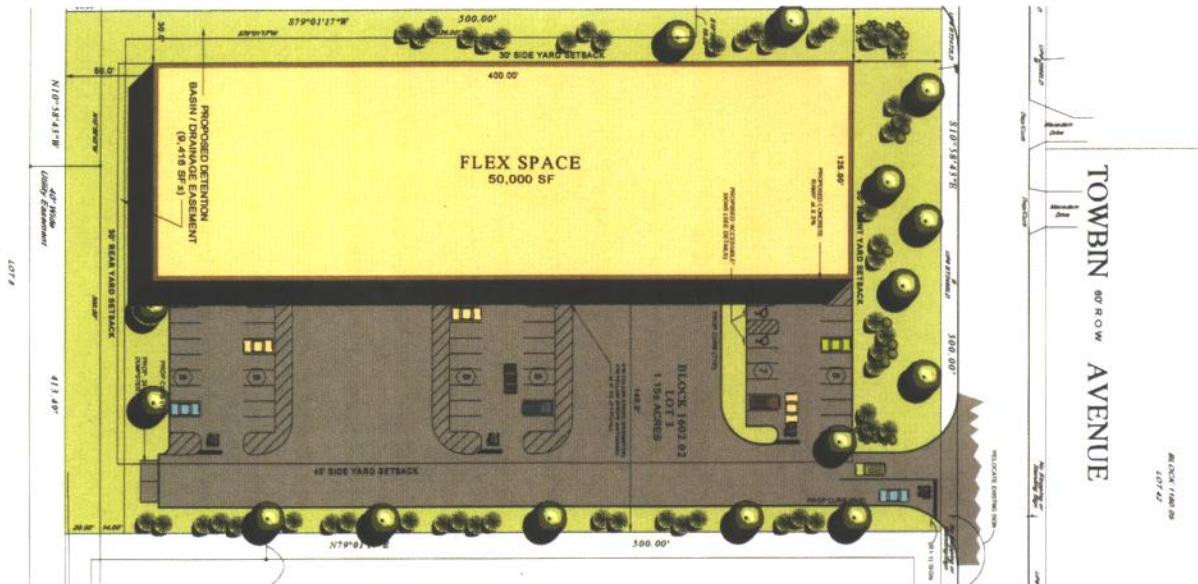

S U D L E R

Sudler Management Company
 300 Interpace Parkway
 Parsippany, NJ 07054-1100
 Telephone: 973-257-0700
 Facsimile: 973-257-0090
 E-Mail: www.sudlerco.com